

BUTT FUSION FITTINGS

BGF FLANGE ADAPTER

FOR REFERENCE ONLY

IPS

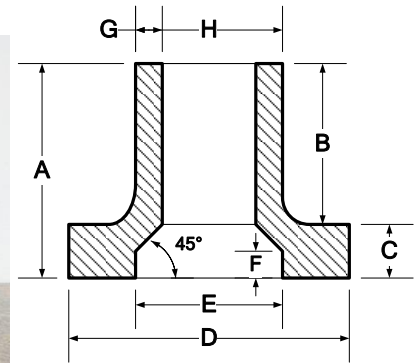

2

Nominal Pipe Size	A Length ¹	B Length ¹	C Flange Thickness	D Flange OD	E Inside ID	F Height	G Wall	H OD
2" IPS	7.250" min	6.900"	.375/.500	3.850" ^{+0.100}	2.070" ^{+0.060}	.250" ^{+0.125}	.216/.259	2.375" ^{+/-0.010}
mm	184.15	175.26	9.52/12.70	97.79	52.58	6.35	5.48/6.58	60.33
3" IPS	5.900" min	5.100"	.800/.900	5.000" ^{+0.050}	3.100" ^{+0.060}	.250" ^{+0.125}	.318/.382	3.500" ^{+/-0.012}
mm	149.86	129.54	20.32/22.86	127.00	78.74	6.35	8.08/9.70	88.90
4" IPS	6.000" Min	5.300"	1.000/1.050	6.540" ^{+0.110}	4.030" ^{+0.060}	.250" ^{+0.125}	.409/.491	4.500" ^{+/-0.015}
mm	152.40	134.62	25.40/26.67	166.12	102.36	6.35	10.39/12.47	114.30
6" IPS	7.800" min	7.000"	1.100/1.150	8.600" ^{+0.050}	6.060" ^{+0.060}	.250" ^{+0.125}	.602/.723	6.625" ^{+/-0.018}
mm	198.12	177.80	27.94/29.21	218.44	153.92	6.35	15.30/18.36	168.28
8" IPS	8.800" Min	7.750"	1.350/1.600	10.700" ^{+0.050}	7.930" ^{+0.060}	.250" ^{+0.125}	.784/.941	8.625" ^{+/-0.025}
mm	223.52	196.85	34.29/40.64	271.78	201.42	6.35	19.92/23.90	219.08
10" IPS	11.400" min	9.975"	1.493/1.593	12.750" ^{+0.050}	10.000" ^{+0.060}	.500" ^{+0.125}	.977/1.173	10.750" ^{+/-0.027}
mm	289.56	253.37	37.92/40.46	323.85	254.00	12.70	24.82/29.79	273.05
12" IPS	12.000" min	10.550"	1.772/1.872	15.500" ^{+0.050}	11.930" ^{+0.060}	.750" ^{+0.125}	1.159/1.391	12.750" ^{+/-0.036}
mm	304.80	267.97	45.00/47.54	393.70	303.02	19.05	29.44/35.33	323.85

¹ All values are nominal dimensions

² Drawing may not be exact representation of product

Note: Please contact a Rahn Customer Sales Rep for availability

Note: All Wall measurements calculated using SDR 11

Note: See SDR Chart for other wall thicknesses



Rahn Plastics Incorporated
 54 Ferris Dr, North Bay (Local) 1-705-495-6777
 Ontario, Canada, P1A 4M3 (Toll Free) 1-888-433-0111
www.rahnplastics.com (Fax) 1-866-495-6820